

# CT12-150X

## 12V150Ah

The rechargeable batteries are lead-lead dioxide systems. The dilute sulfuric acid electrolyte is absorbed by separators and plates and thus immobilized. Should the battery be accidentally overcharged producing hydrogen and oxygen, special one-way valves allow the gases to escape thus avoiding excessive pressure build-up. Otherwise, the battery is completely sealed and is, therefore, maintenance-free, leak proof and usable in any position.

### Construction

Component	Positive plate	Negative plate	Container	Cover	Safety valve	Terminal	Separator	Electrolyte
Raw material	Lead dioxide	Lead	ABS	ABS	Rubber	Copper	Fiberglass	Sulfuric acid

### General Features

- Absorbent Glass Mat (AGM) technology for efficient gas recombination of up to 99% and freedom from electrolyte maintenance or water adding.
- Not restricted for air transport-complies with IATA/ICAO Special Provision A67.
- UL-recognized component.
- Can be mounted in any orientation.
- Computer designed lead, calcium tin alloy grid for high power density.
- Long service life, float or cyclic applications.
- Maintenance-free operation.
- Low self discharge.
- Case and cover available in both standard and flame retardant ABS.

### Technology Parameter

Battery model	CT12-150X		
Nominal voltage	12V		
Number of cell	6		
Capacity (20°C)	10hR(15A, 10.8V)	5hR(24.5A, 10.5V)	1hR(9.9 A, 9.60V)
	150Ah	122.5 Ah	99Ah
Dimensions Max.	Length	Width	Total Height
	548±2 mm	105±2 mm	316±2 mm
Approx. weight	44.2Kg (97.5lbs)		
Internal resistance	Full charged at 20°C: 4.5mOhms		
Self discharge	3% of capacity declined per month at 20°C (average)		
Operating temperature range	Discharge	Charge	Storage
	-20~60°C	-10~60°C	-20~60°C
Max. discharge current (20°C)	1050A (5s)		
Short circuit current	2680A		

### Dimensions and Weight

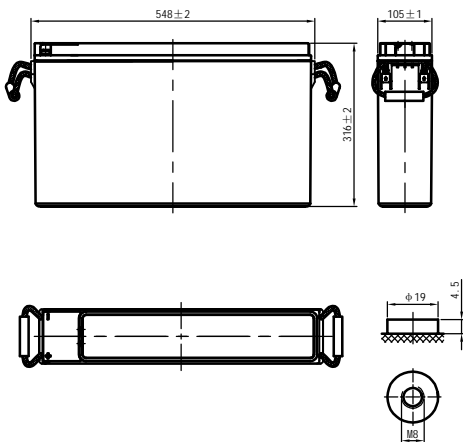

### Discharge Constant Current (Amperes at 68°F20°C)

End Point Volts/cell	15min	30min	45min	1h	3h	5h	10h
1.60	239	158	122	99.0	41.7	25.4	15.4
1.65	225	153	119	97.2	41.0	25.1	15.3
1.70	209	147	114	94.5	40.1	24.8	15.2
1.75	191	140	110	91.8	39.3	24.5	15.1
1.80	176	131	104	88.7	38.4	24.0	15.0

### Discharge Constant Power (Watts at 68°F20°C)

End Point Volts/cell	15min	30min	45min	1h	2h	3h	5h
1.60	403	266	209	171	106	78.8	51.7
1.65	382	257	203	167	104	77.6	50.9
1.70	357	247	196	163	103	76.1	50.1
1.75	332	234	189	158	99.9	74.6	49.1
1.80	304	221	180	151	96.3	73.1	48.2

(Note) The above characteristics data are average values obtained within three charge/discharge cycles not the minimum values.

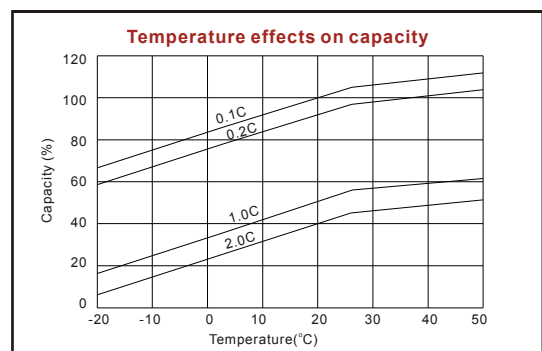
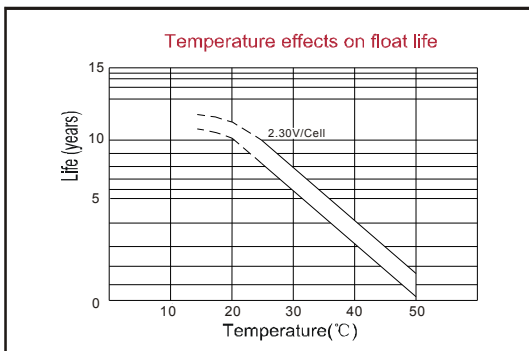
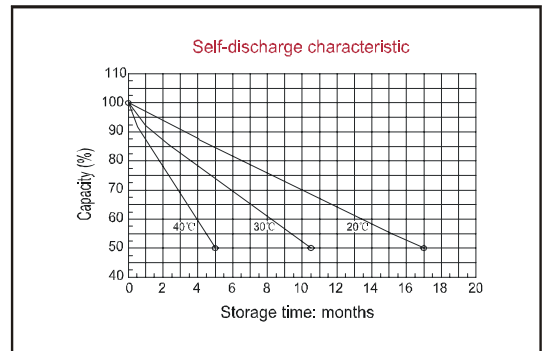
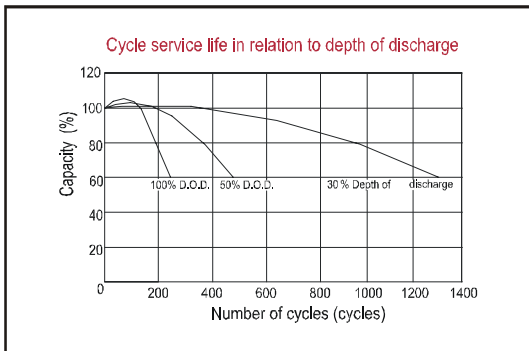
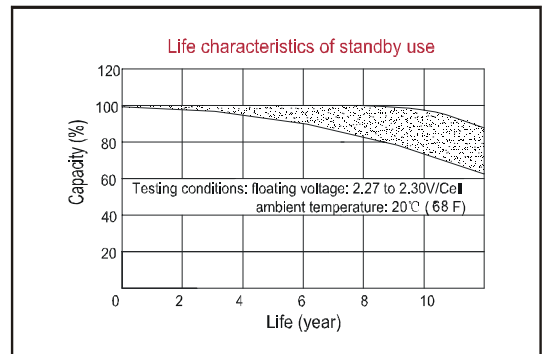
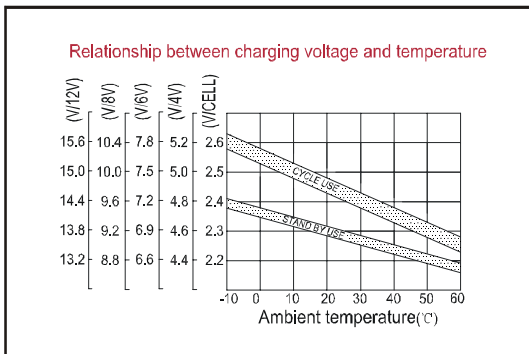
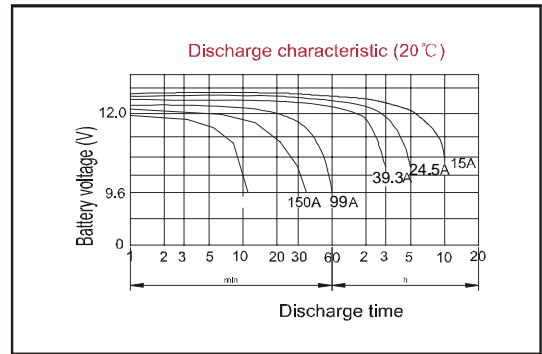
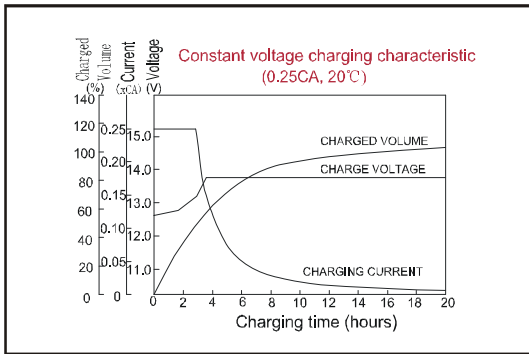

**Shenzhen Center Power Tech. Co., Ltd.**  
 Center Power Industrial Park, Tongfu Industrial District Dapeng Town,  
 518120 Shenzhen, China  
 Tel: +86-755-8431 8088 Fax: +86-755-8431 8038  
 Email: sales@vision-batt.com

